

# OPEN CREATIVE LAYOUT

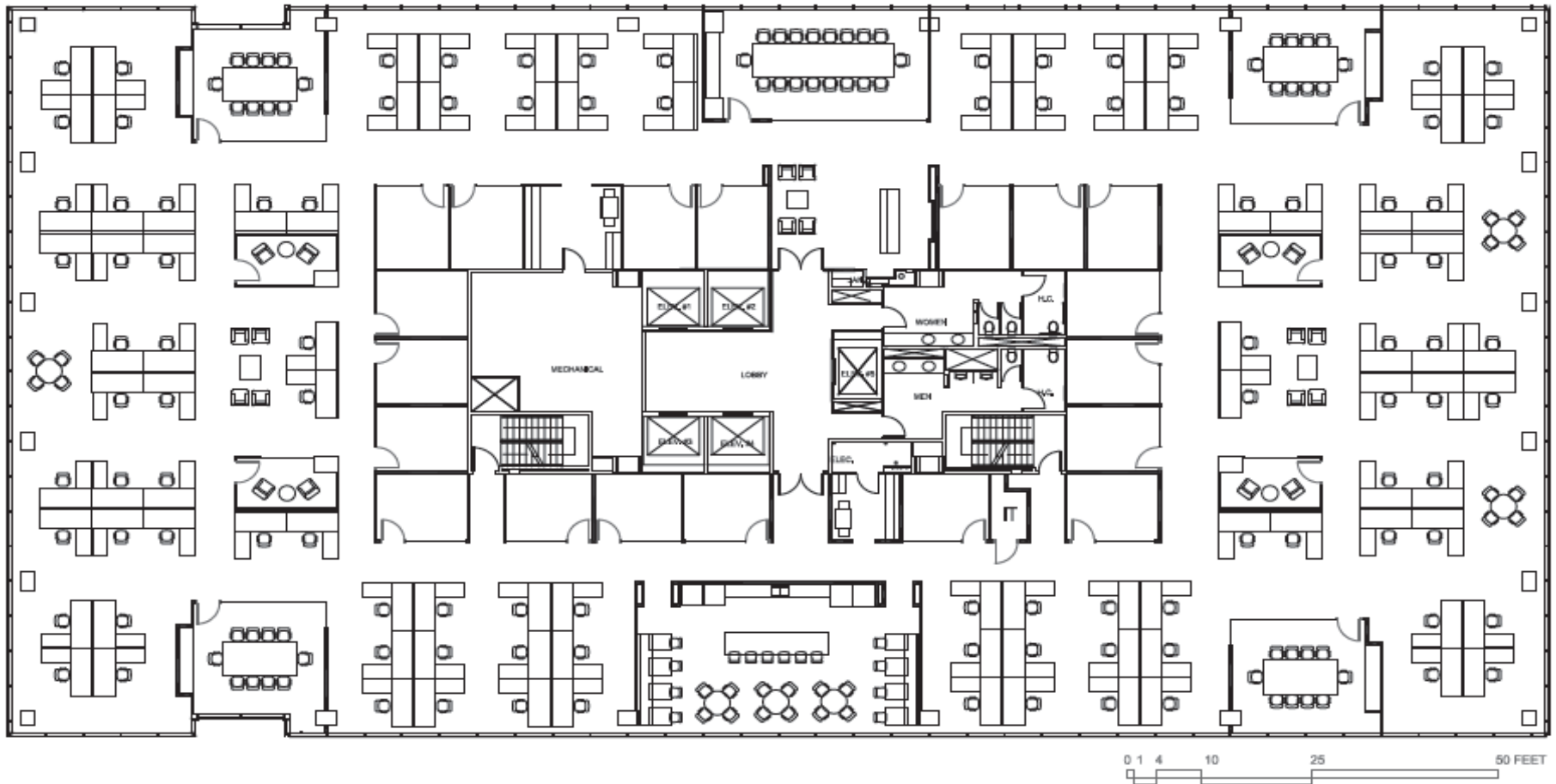

- 100 WORKSTATIONS
- 19 OFFICES
- 2 COPY ROOMS
- 5 CONFERENCE ROOMS
- 1 BREAK ROOM

22,898 RSF

FOR LEASING INFORMATION

**Doug Little** 713.272.1284 / [Doug.Little@transwestern.com](mailto:Doug.Little@transwestern.com)

**David Baker** 713.407.8701 / [David.Baker@transwestern.com](mailto:David.Baker@transwestern.com)

**Kelli Gault**

713.410.1220 / [Kelli.Gault@transwestern.com](mailto:Kelli.Gault@transwestern.com)

**Jack Scharnberg**

713.407.8717 / [Jack.Scharnberg@transwestern.com](mailto:Jack.Scharnberg@transwestern.com)