



MT02

6.25-inch Motorcycle Smart Screen

Product manual



1. Product Overview

The MT02 uses two wide-angle cameras mounted on the front and rear of the motorbike to capture images of the surrounding area and transmit them to the device in real time. It records all driving videos and photos at the touch of a button. The system also allows drivers to connect their mobile phones, use motorbike navigation, play music and more. The product's housing effectively prevents rainwater from entering, so it can be used in rainy and dripping environments.

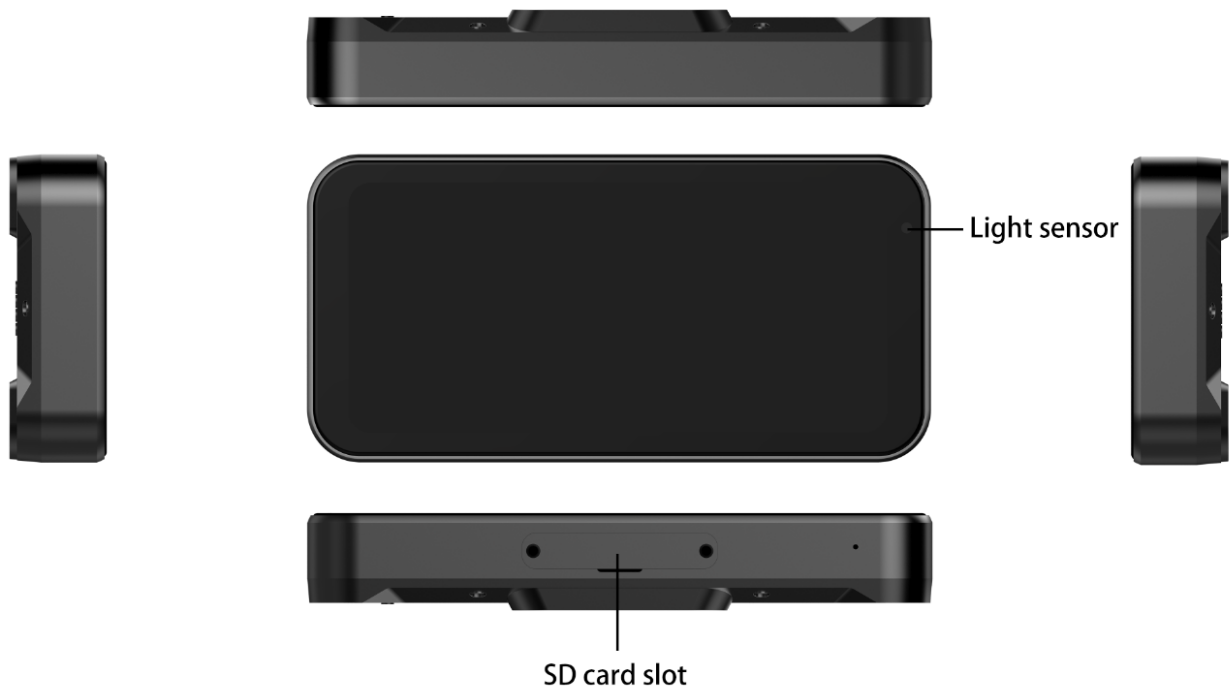

2. Product composition list

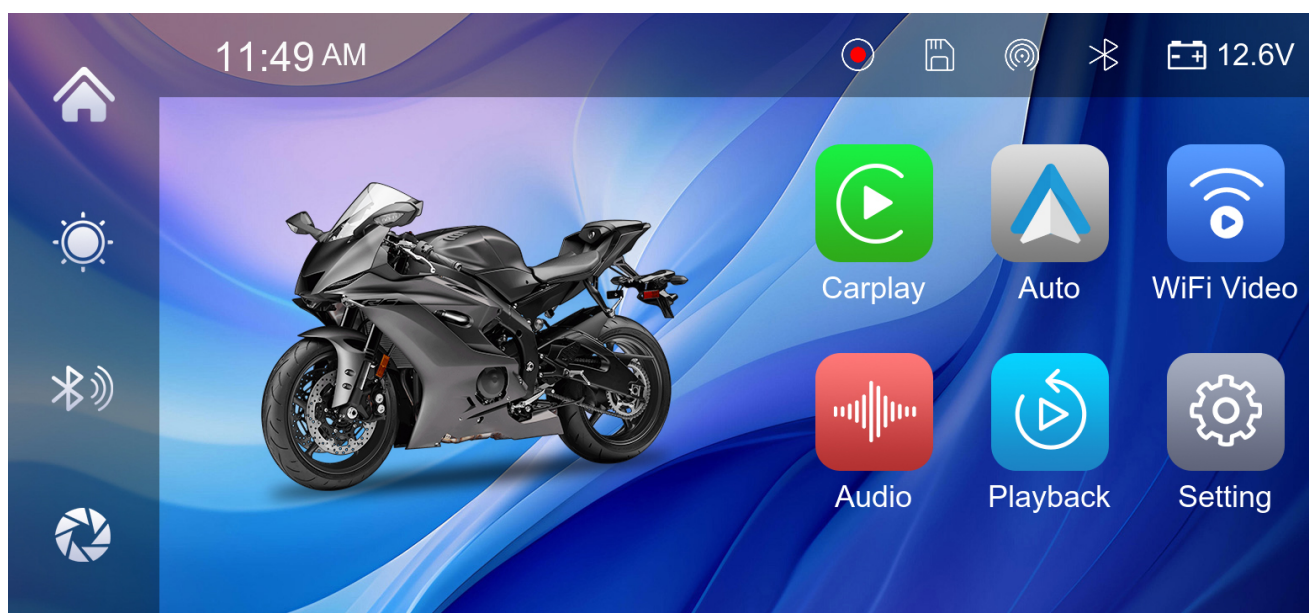

Name	Graphic	Instructions	Number
The host		6.25 inch high-definition display (1560 * 720) / Touch control / Bluetooth / WIFI / Audio / SD card recording	1
The power cord		5V-30V / 2.5A current / ACC power supply	1
Camera		AHD High Definition (1080N)	2
Control box		Support one-touch photo taking, page switching, answering and ending calls, etc.	1
SD card (Optional)		Class10, minimum support 32GB, maximum support 256GB	1

3. Product parameters

Project	Function introduction	Performance indicators
System	Language	Simplified Chinese / Traditional Chinese / English / Russian / Spanish / French / German / Japanese / Korean / Italian / Portuguese
	Operation Interface	Graphical menu operation
	Mode of operation	Touch / keystrokes
Video display	Real-time display	6.25 inch high-definition IPS screen, 1560 * 720
smart connection	Wi-Fi	Supports CarPlay / Auto / WiFi Video
The video store	SD card	Saving recorded videos
Audio part	Audio transmission	Audio
	Microphone	Support microphone recording
Power part	The power input	Support 5V-30V step-down line
Other	Working temperature	-4~149 °F

4. SD card specifications (optional)

The quality of SD card has a great influence on the stability of video recording. In order to record video safely, please choose a big brand SD card, such as SanDisk, Kingston, Toshiba, Samsung, etc. The SD card should be at least Class10 level or above. The minimum capacity supports 32GB and the maximum capacity supports 256GB.

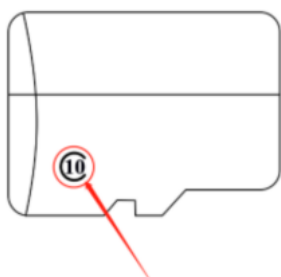

Key Description:

Key	At work	Incoming call
1	Short press: switch to rear view camera screen / return to previous screen. Long press for 10s: Power off.	Short press to answer a call
2	Short press: Take a photo. Long press 3S: Video lock.	Short press to end the call
3	Short press: Return to the main screen / Back to mobile phone screen casting interface. Long press for 5S: turn off / on touch screen function.	/

Only CarPlay mode allows you to use the line box to hang up and answer calls.

5. Wiring and installation instructions

5.1 Main unit wiring diagram

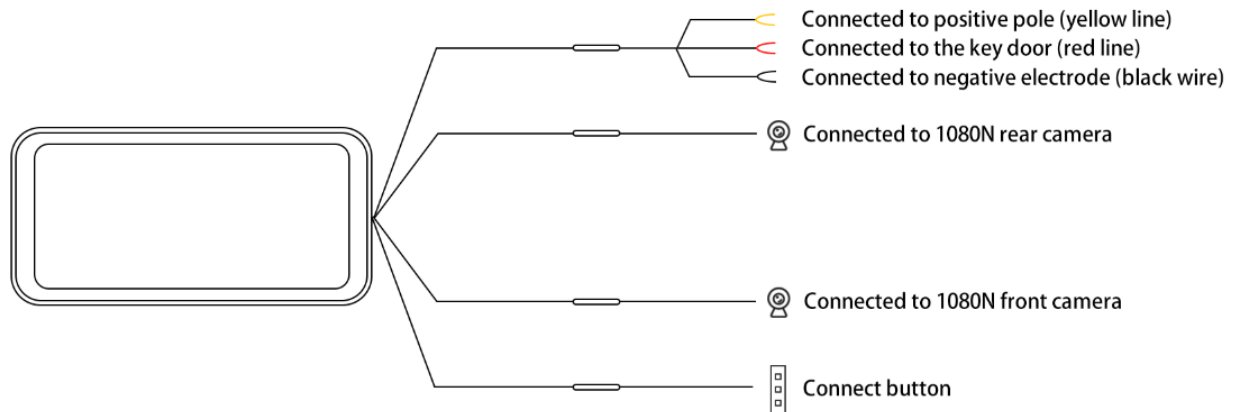

5.2 Sensor installation method

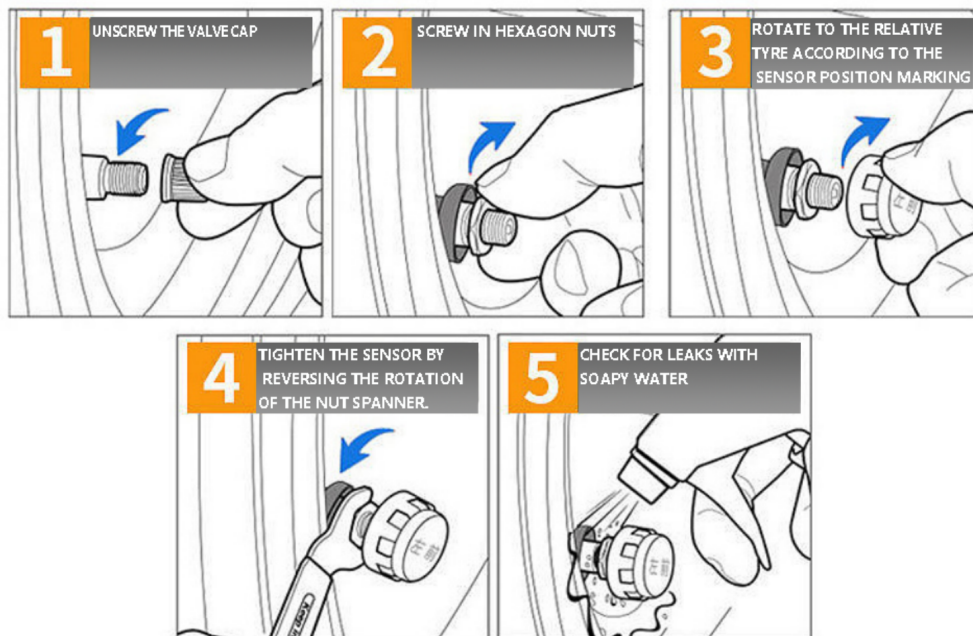

5.3 Loading Instruction Chart

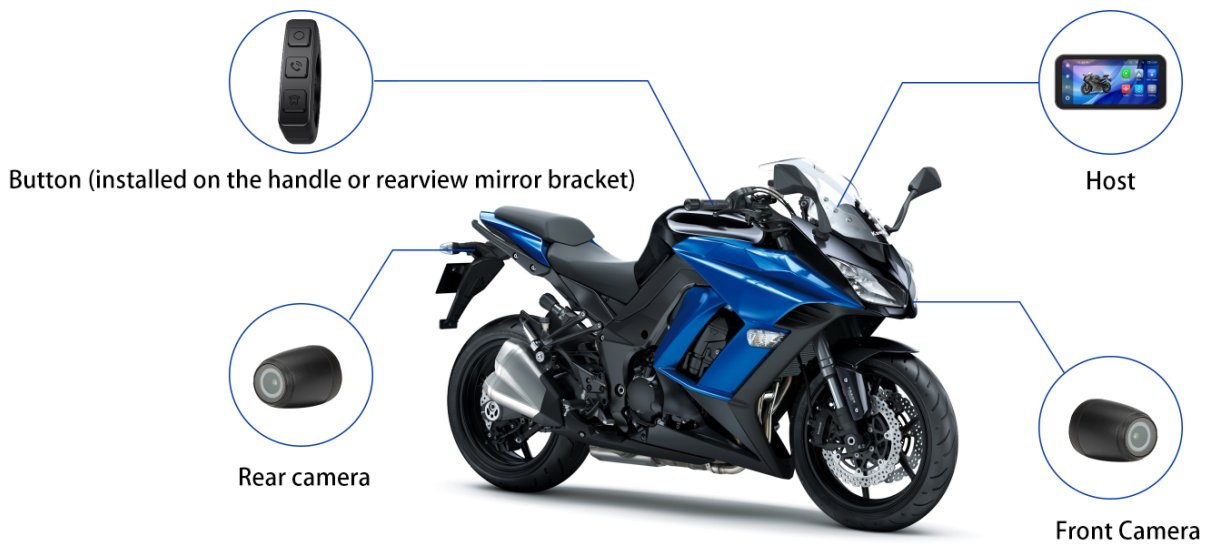

6. Interface Description



1. **Home button:** Click to return to the home page
2. **Brightness key:** Click to adjust screen brightness
3. **Volume button:** Click to go to the Audio screen

4. **Driving monitoring button:** Click to enter the video recording interface
5. **Switch button:** Click to switch back and forth between front camera screen, rear camera screen and motorbike preview.
6. **Record button:** click to start recording video, click again to close the recording video.
7. **Photo button:** Click to take a photo with one click.
8. **Lock button:** lock the current recording video, so that the video will not be lost
9. **CarPlay:** iPhone dedicated projection mode
10. **Auto:** Dedicated interface for Android phones
11. **WiFi Video:** Click to enter the connection mode for watching and recording videos on your phone
12. **Audio:** After connecting to CarPlay/Auto mode, connect the headset with your phone's Bluetooth and all the machine's sounds will be played in the headset.
13. **Playback:** Click to view the recorded video
14. **Settings:** Click to enter the function settings interface

Automatic brightness adjustment:

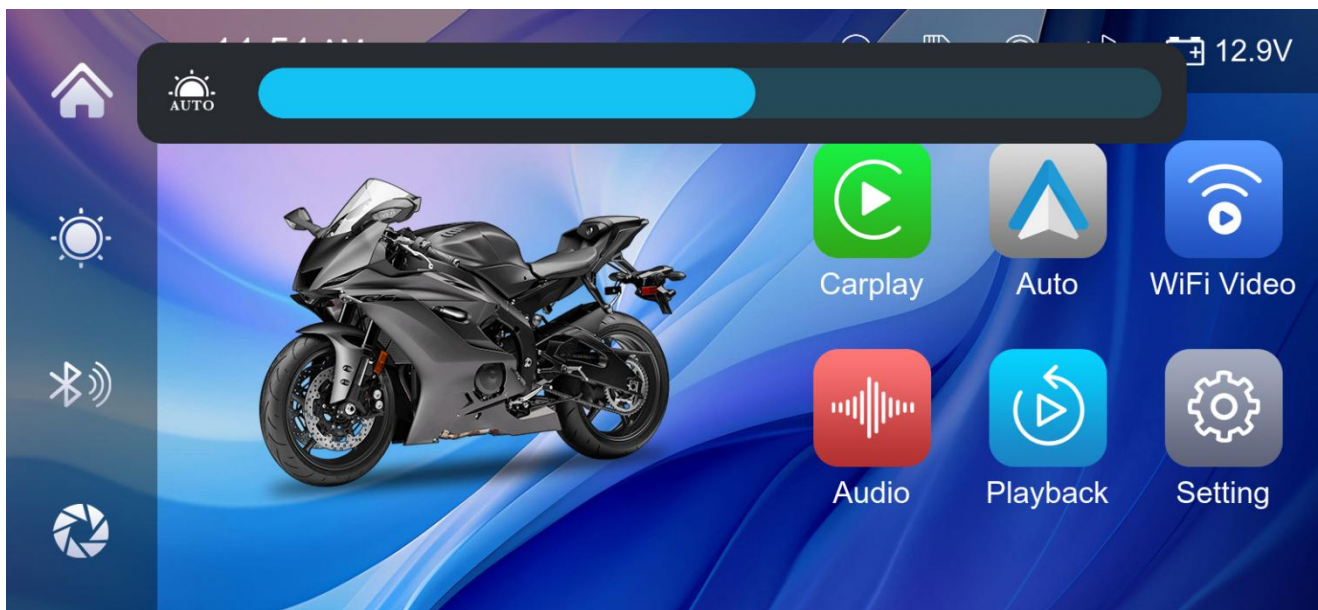

A built-in light sensor on the lower left side of the machine automatically recognises the brightness of the surroundings and adjusts the brightness of the machine's screen for improved comfort. It is not possible to adjust the brightness manually in auto-brightness mode.

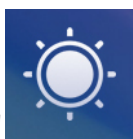

Click the ' ' button on the sidebar, and then click ' '











' to turn off the automatic brightness adjustment function.

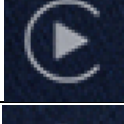

Tap ' ' to switch to auto-brightness mode.

Status bar icon description:

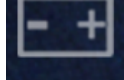
	Indicates that recording is in progress
	Indicates that Bluetooth is turned on
	Indicates that Bluetooth is connected
	Indicates that the machine's WiFi is turned on
	Indicates being in CarPlay projection mode
	Indicates being in Auto screen projection mode
	Indicates that the SD card has been inserted
	Indicates that the SD card has not been inserted
	Indicates that the touch control function has been turned off
	Motorbike battery voltage

Rainwater mode (lock screen):

To prevent the screen from being accidentally touched by rain drops on a rainy day. You can long press the third button of the cable box for 5 seconds to turn on the rain mode. When this mode is turned on, the screen touch will be turned off and can be unlocked by long pressing the third button of the cable box again for 5 seconds.

A. CarPlay

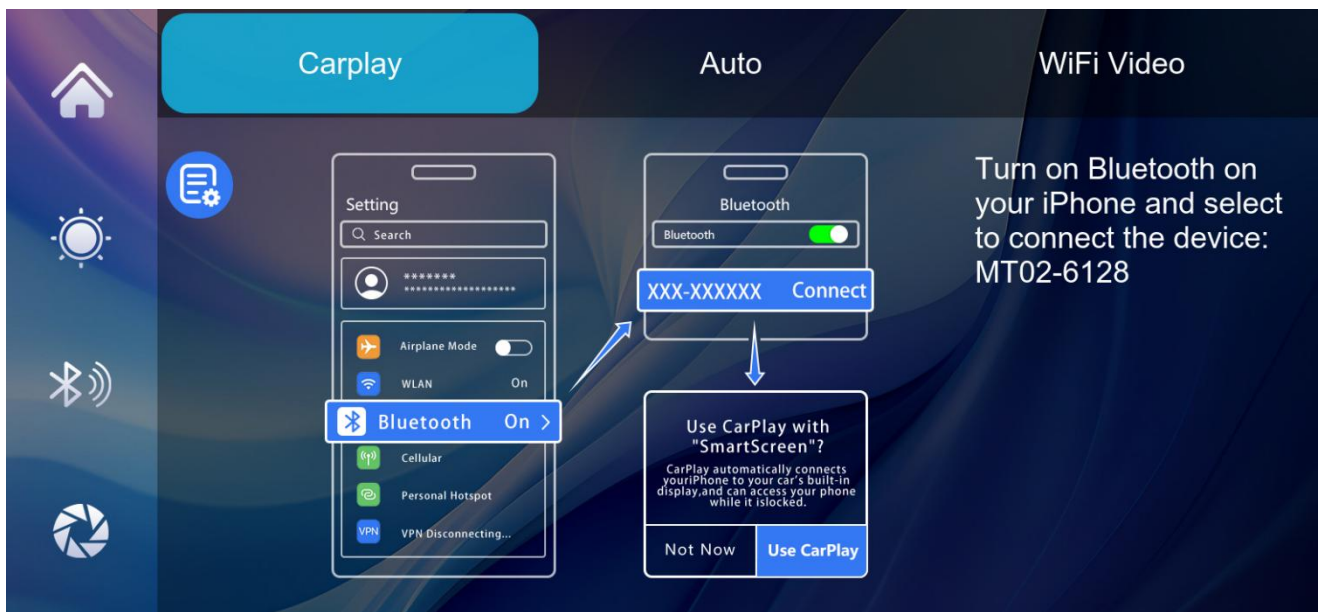

As shown in the above figure, click the 'CarPlay' button, then select the 'CarPlay' option, and first turn on the phone's WiFi and Bluetooth, as shown in the above figure. Bluetooth will automatically turn on, named MT02-XXXX. Once Bluetooth is successfully connected, you can connect to CarPlay. (When the machine is powered on, it will attempt to automatically connect to the last connected phone)

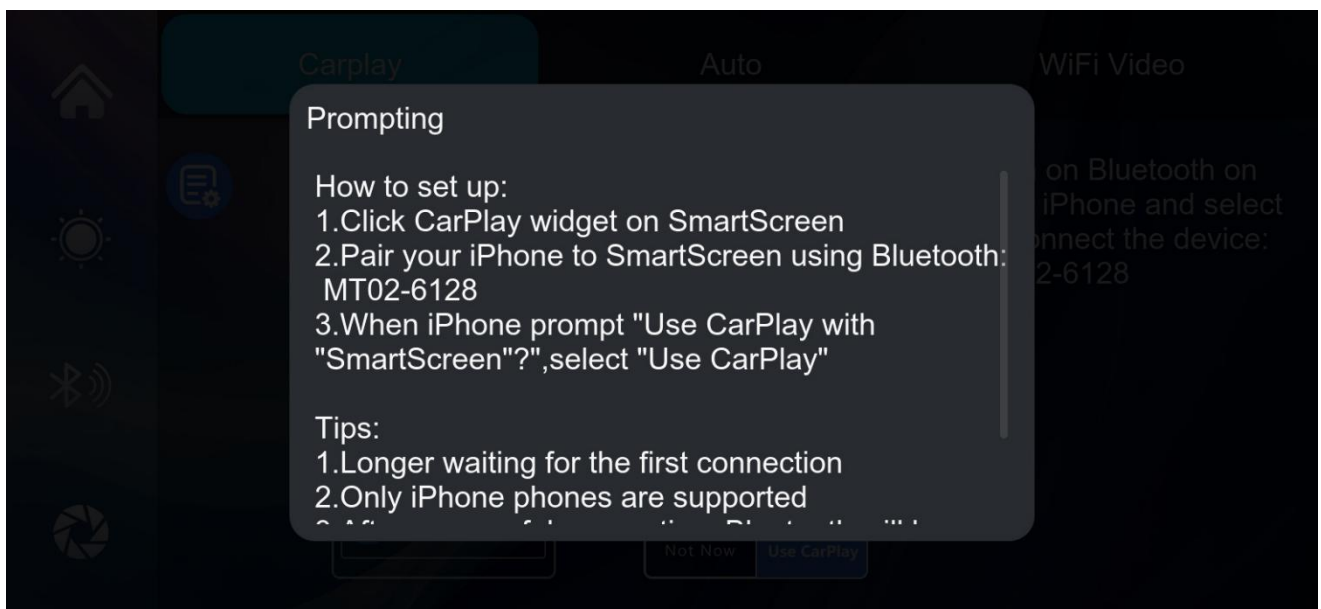

Click the Details button for detailed connection steps and connection FAQs.

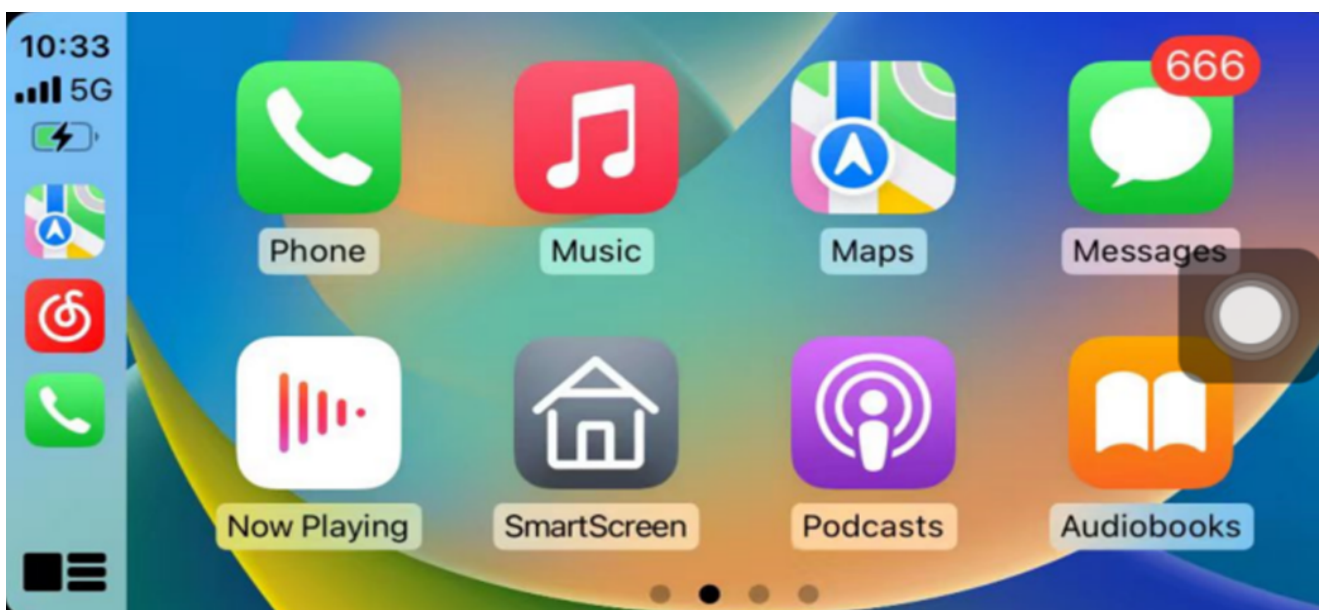

Click Assistive Touch to display the shortcut menu: [Back to Home], [Record Video Screen], [Volume Adjustment], [Brightness Adjustment].

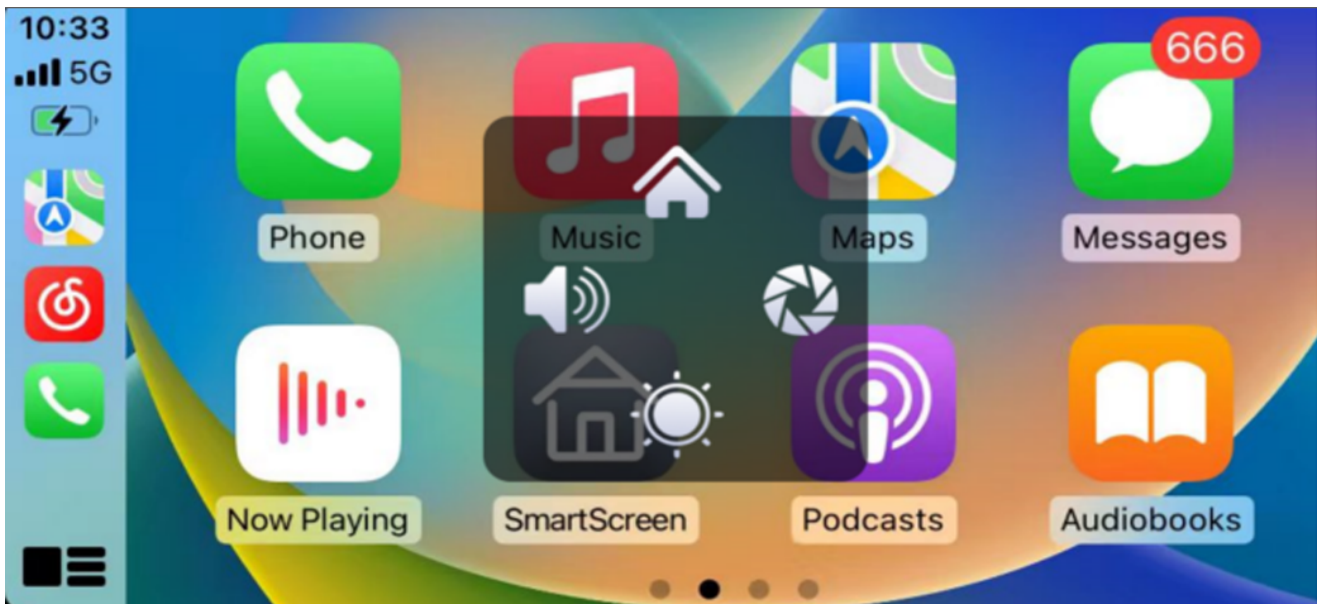

When Assistive Touch is turned off, you can tap the [SmartScreen] button to return to the home page.

(CarPlay option is only supported for Apple mobile phones. Please turn off the Bluetooth button and then the WiFi button in your phone's settings to disconnect.)

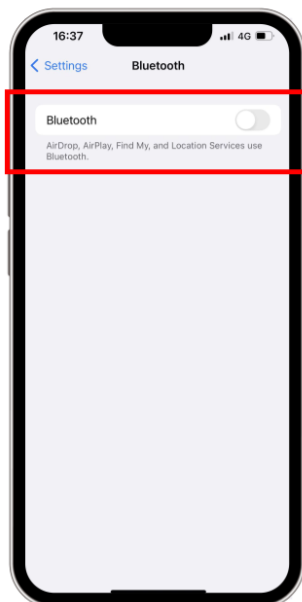

1

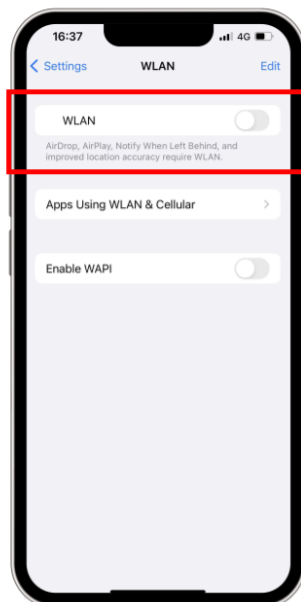

2

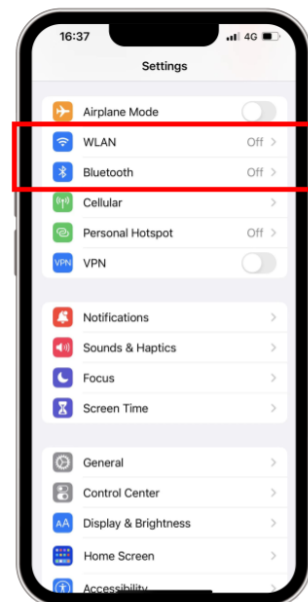

3

B. Auto

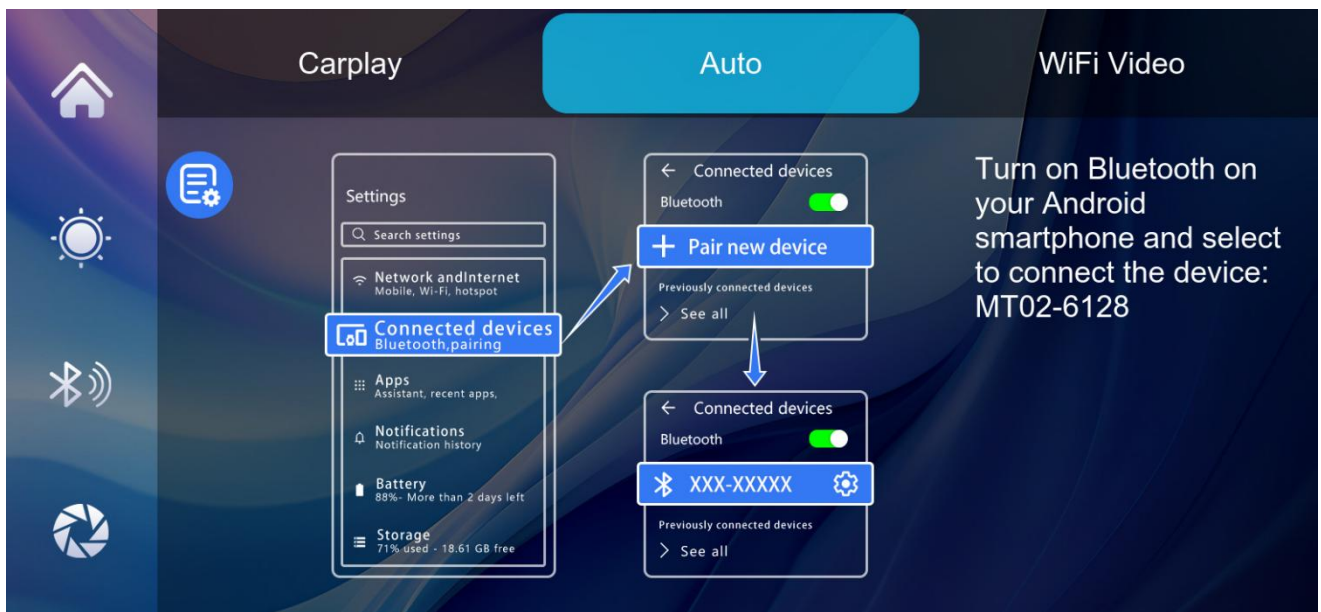

As shown in the picture, click the [Auto] button, and then select the [Auto] option, first turn on the phone's Wi-Fi and Bluetooth, as shown in the picture above. Bluetooth will be turned on automatically and the name will be MT02-XXXX. Once the Bluetooth is successfully connected, you can connect to Auto. (When the machine is powered on, it will try to automatically connect to the last connected phone)

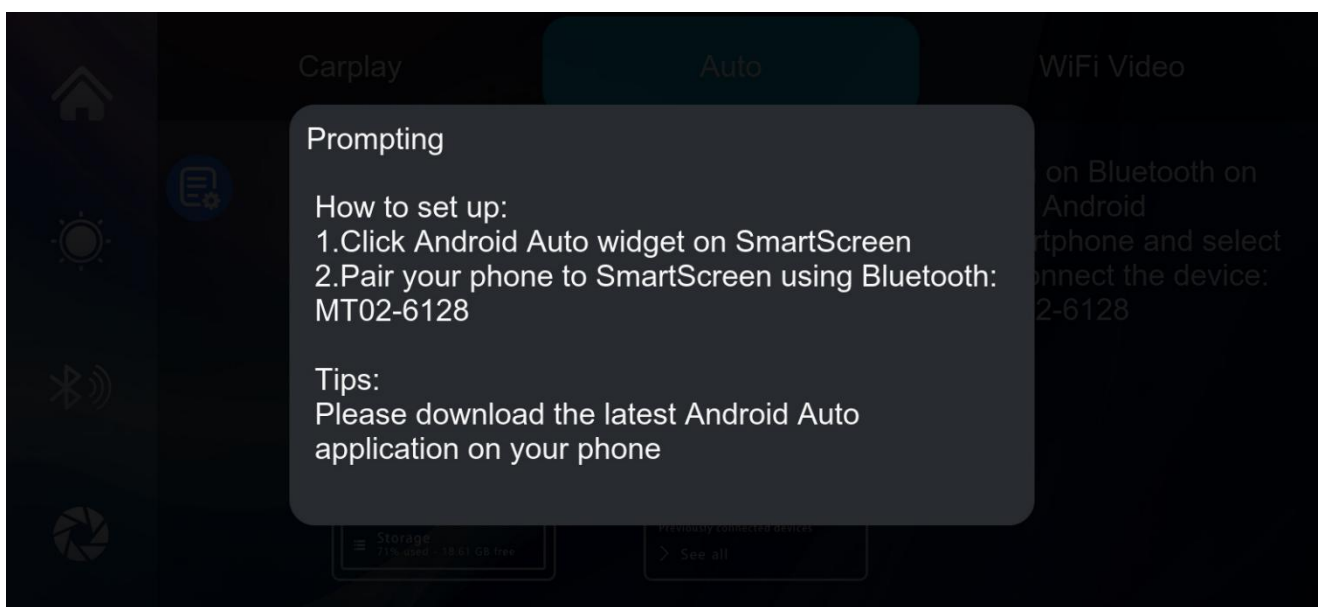



Click the Details button for detailed connection steps and connection FAQs.

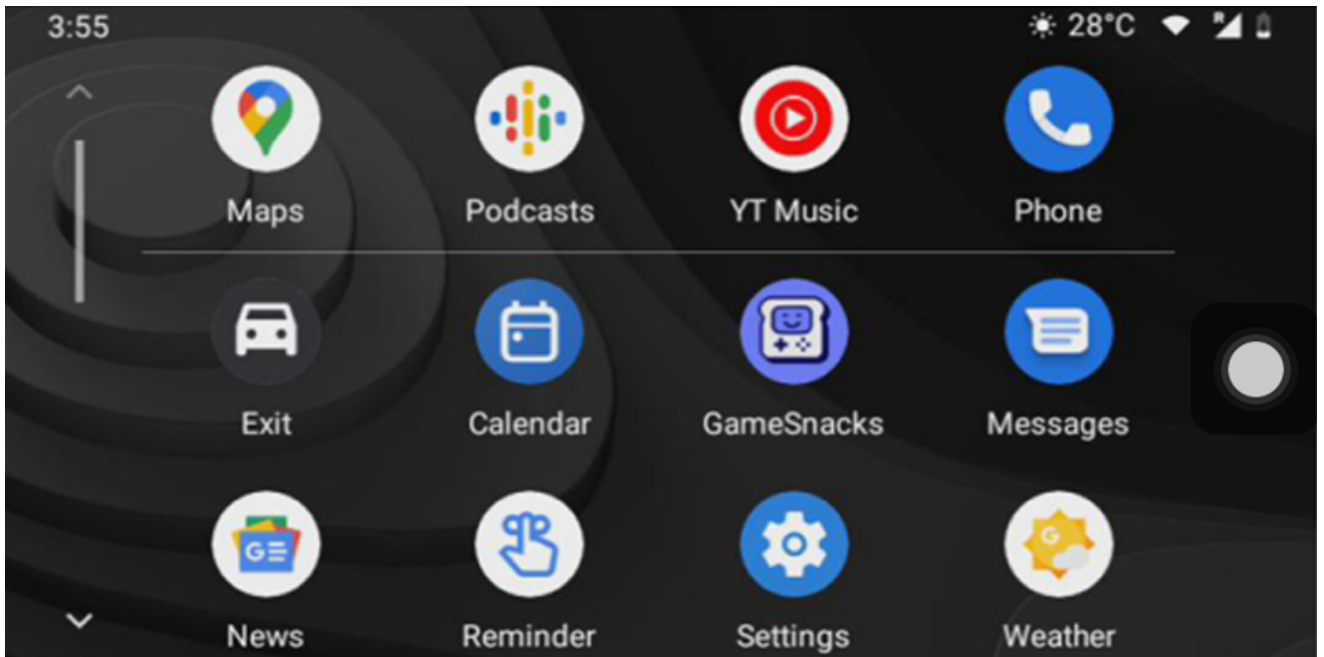

Click Assistive Touch to display the shortcut menu: [Back to Home], [Record Video Screen], [Volume Adjustment], [Brightness Adjustment].

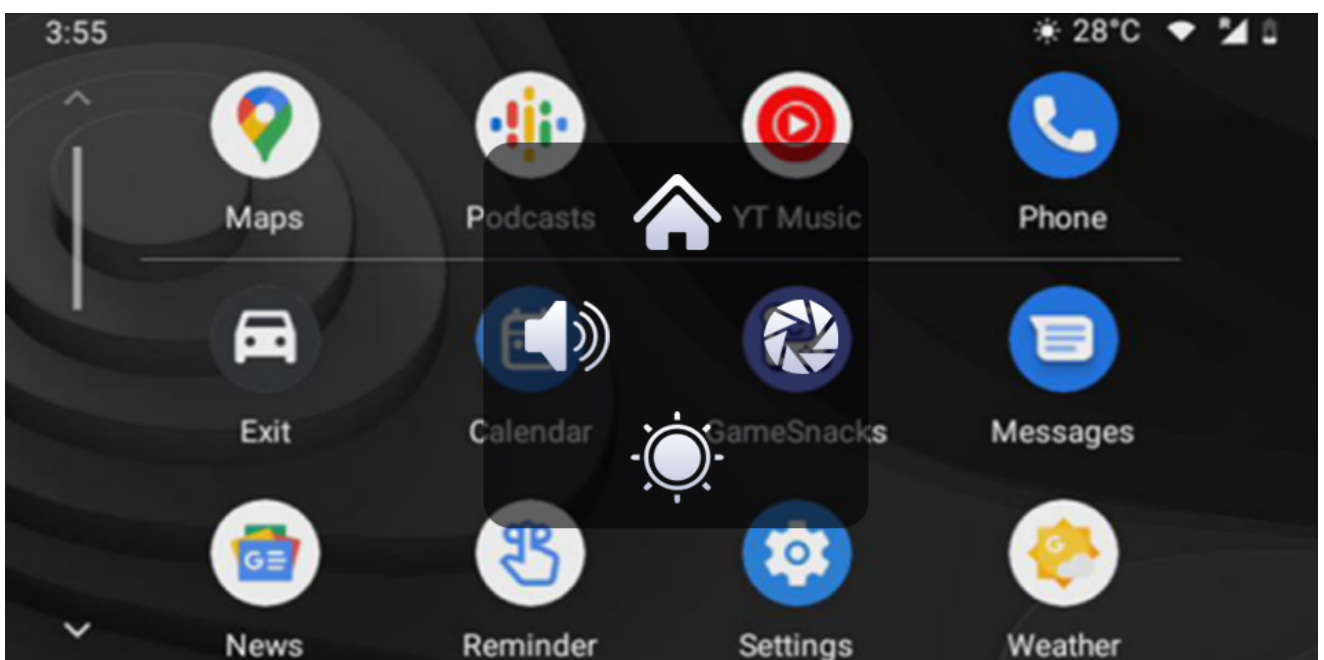

When Assistive Touch is turned off, you can tap the [Exit] button to return to the home page.

(Wireless Auto option is only supported for Android phones. Please forget Bluetooth in your phone's settings and turn off the WiFi button to disconnect).

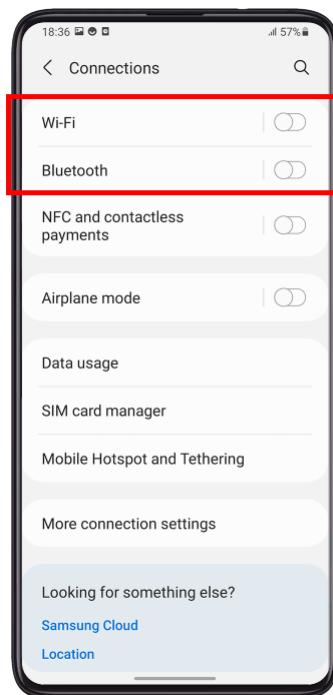

C. WiFi video



As shown in the above figure, first scan the QR code to download the corresponding app.

After downloading, open the app and follow the prompts to connect to the machine's WiFi. WiFi name: RTSP-XXXXXX, password as shown on the machine.

After connecting, the machine will enter the recording interface and cannot perform any operations. You can watch or download recorded videos, set machine parameters, and more on your phone.

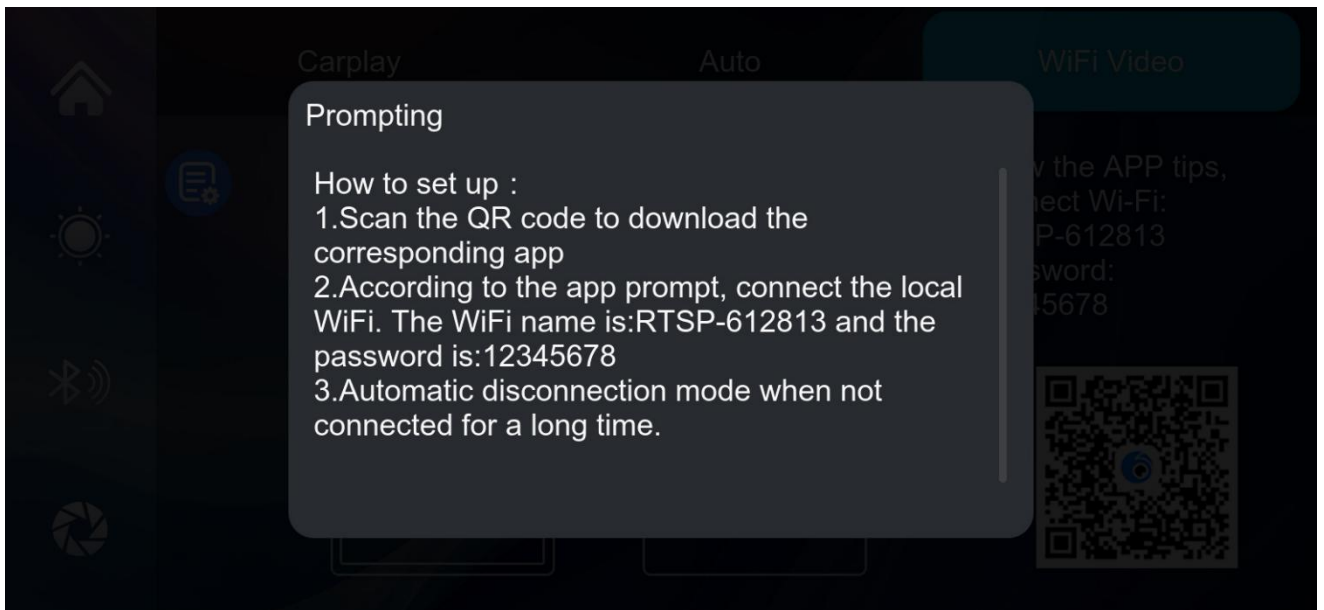

Click the Details button for detailed connection steps and connection FAQs.

(Turn off the WiFi key on your phone to disconnect, and it will take one minute to disconnect before you can operate on the machine.)

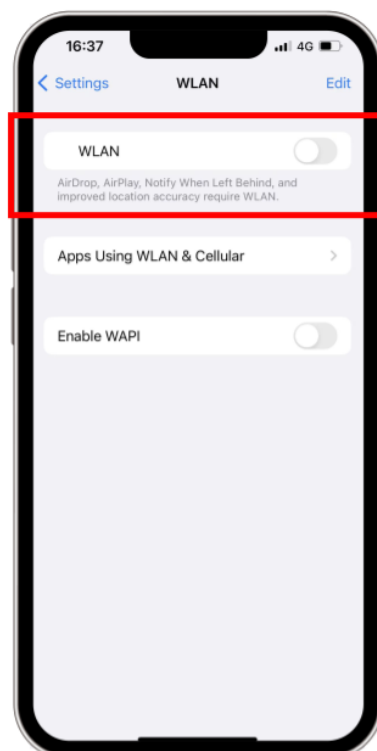





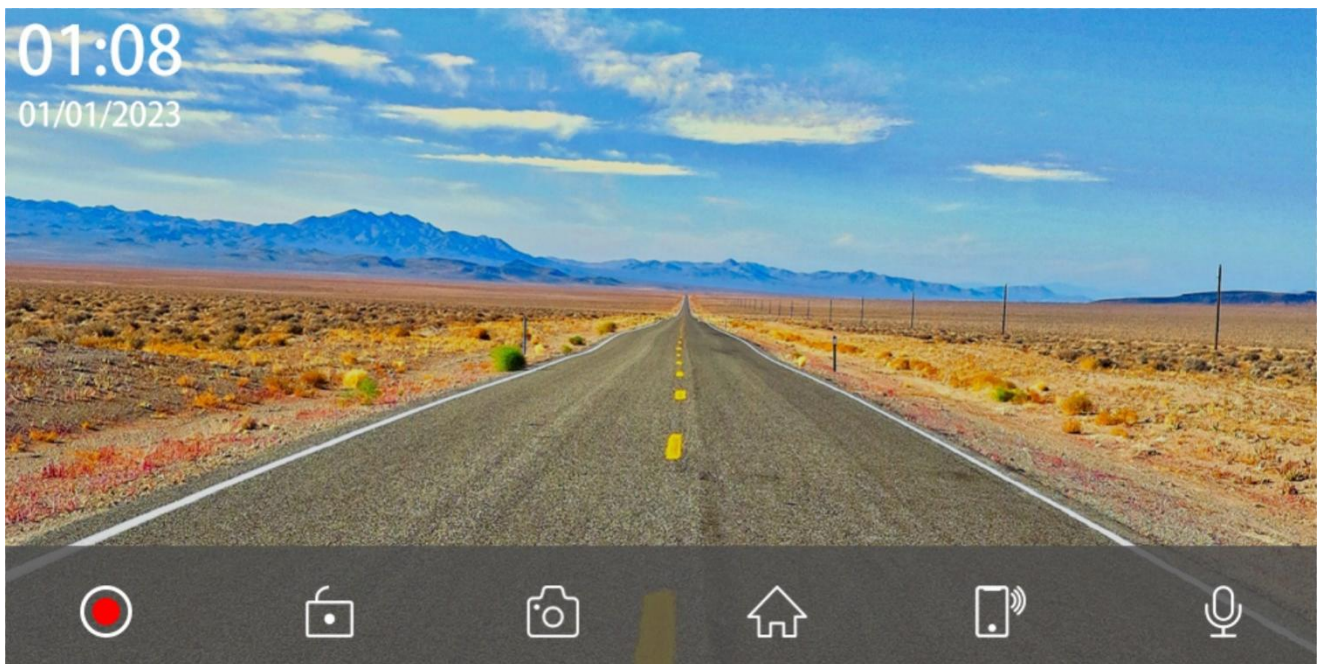

D. DVR

As shown in the picture, the main page will not display the camera image, you need



to click the Dvr button [] to view the camera image. After inserting the memory card, the system automatically enters the recording mode.



	Tap to start recording the video and tap again to close the recorded video.
	Lock the recorded video and the data will not loop over the recording.
	Click to take a photo with one click.
	Click to return to the main interface
	Click to quickly return to the mobile Internet interface
	Turn recording sound on or off.

Lock the current video:

If too many videos are locked, **the first locked video will be overwritten.**

The number of videos that can be locked depends on the capacity of the SD memory card. 32G SD memory card can lock 40 videos, when locking the 41st video, the 41st video will overwrite the first one and the 42nd video will overwrite the second one.

64G SD memory card can store 80 locked videos, 128G SD memory card can store 160 locked videos, 256G SD memory card can store 320 locked videos.

The SD card supports a minimum of 32GB and a maximum of 256GB!

E. Audio

As shown in the above figure, click the [Audio] button to enter the Audio selection interface.

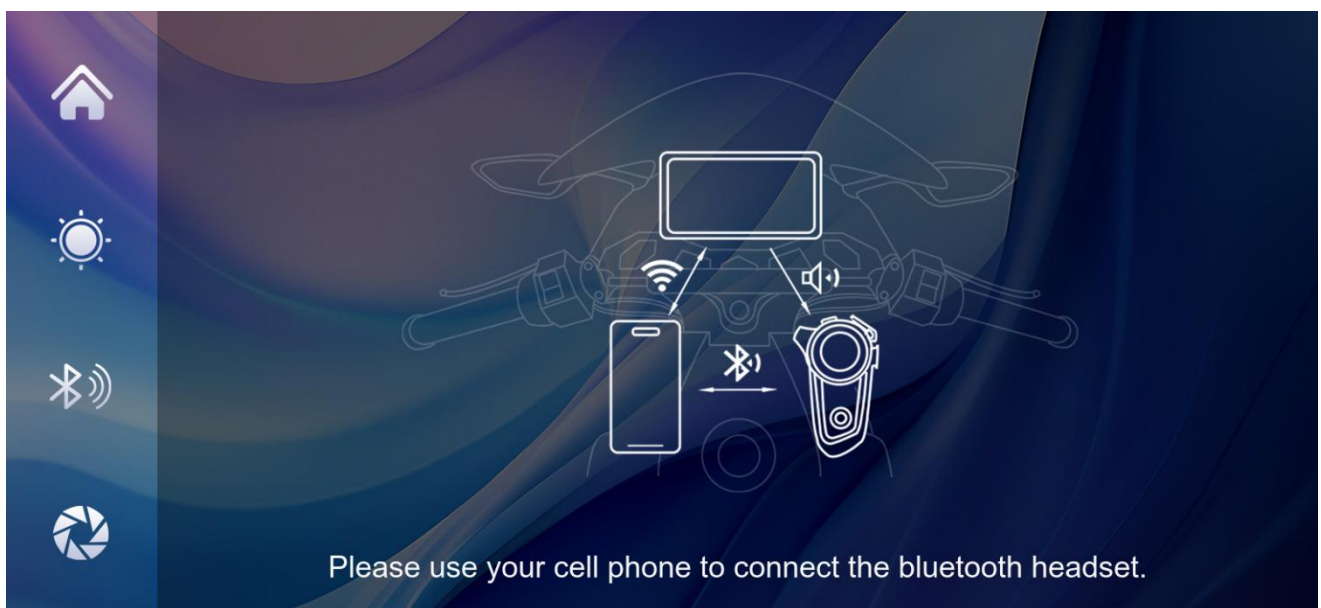

After connecting [CarPlay] or [Auto] for screen casting, you can use your phone's Bluetooth to connect to the motorcycle Bluetooth headset. After the connection is successful, all sounds from the device will be transmitted to the motorcycle Bluetooth headset for playback.

F. Playback

As shown in the above figure, click the [Playback] button to enter the Playback interface.

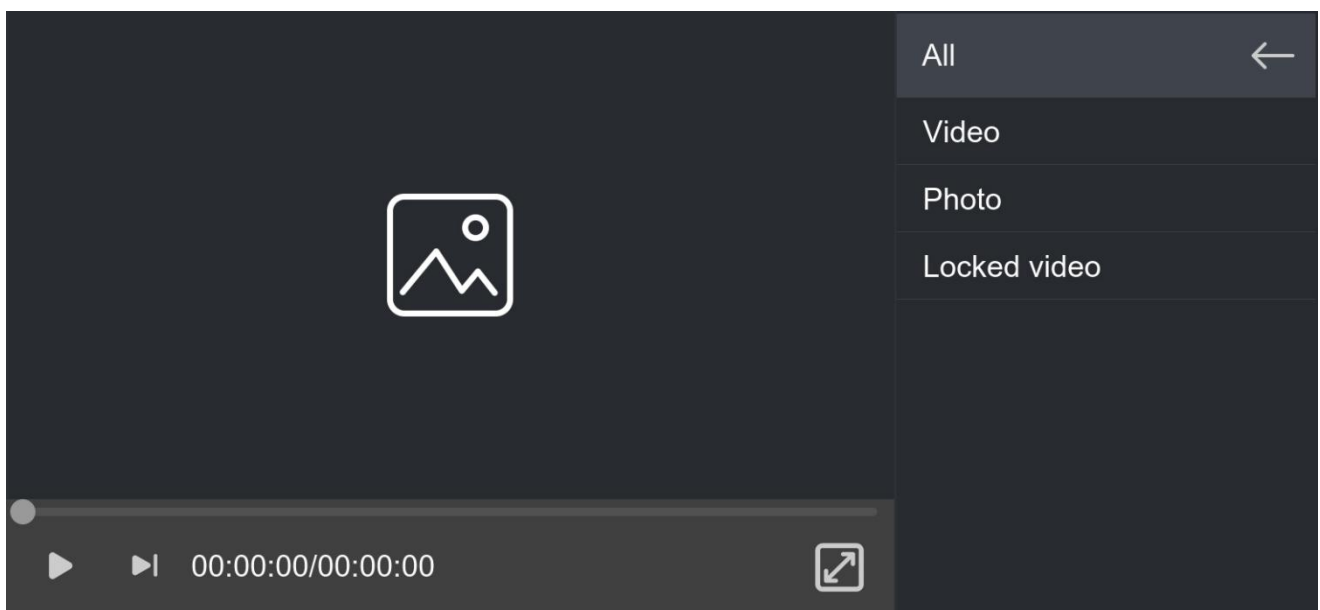

You can select [Video], [Photo], [Locked Video] folder, after selecting, you can click the select button on the right side of the file to delete, lock or unlock the video.

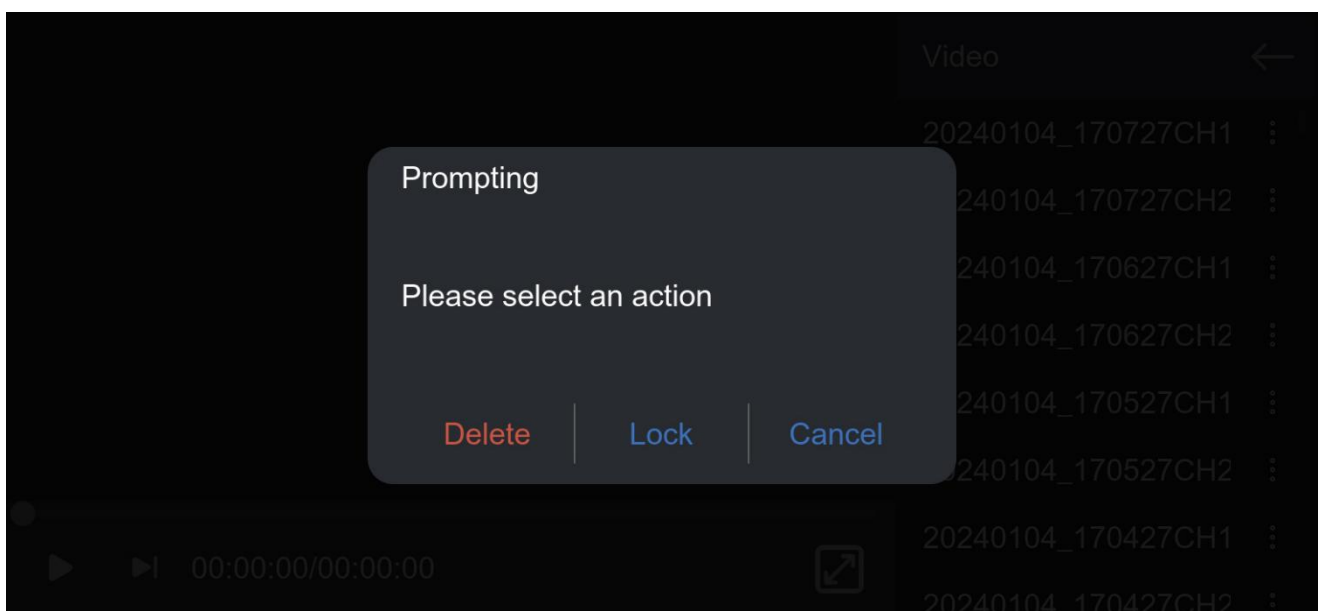
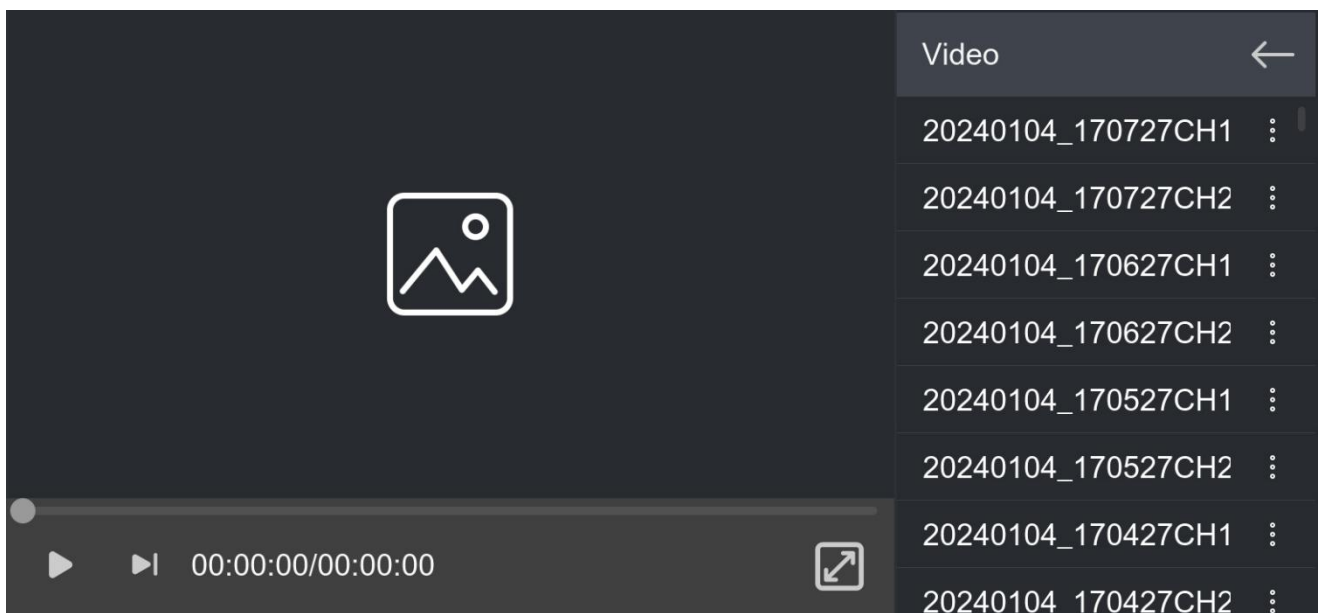

Click to play or pause the video.



Click to switch to the next video or photo.



Click the Full Screen button to play the video in full screen.



Click to return to the previous screen.

G. Settings

The setting options are divided into 3 sections: General, Camera, System.





General: Brightness, Assistive touch, Clear connections, Touch mode

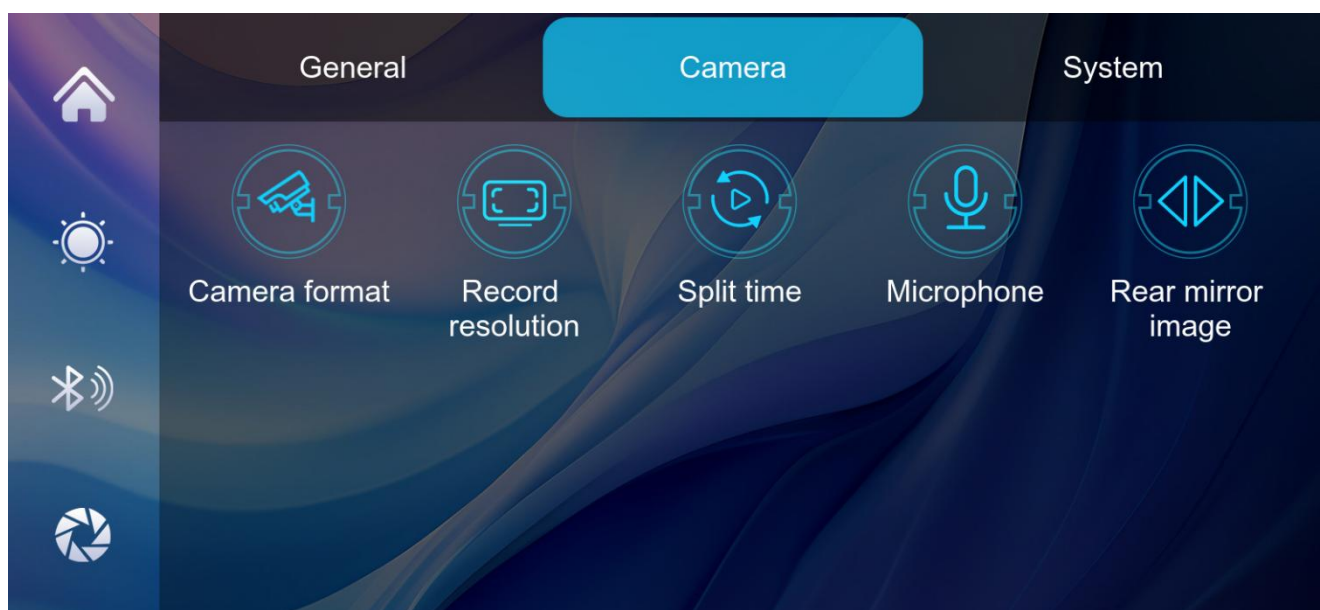
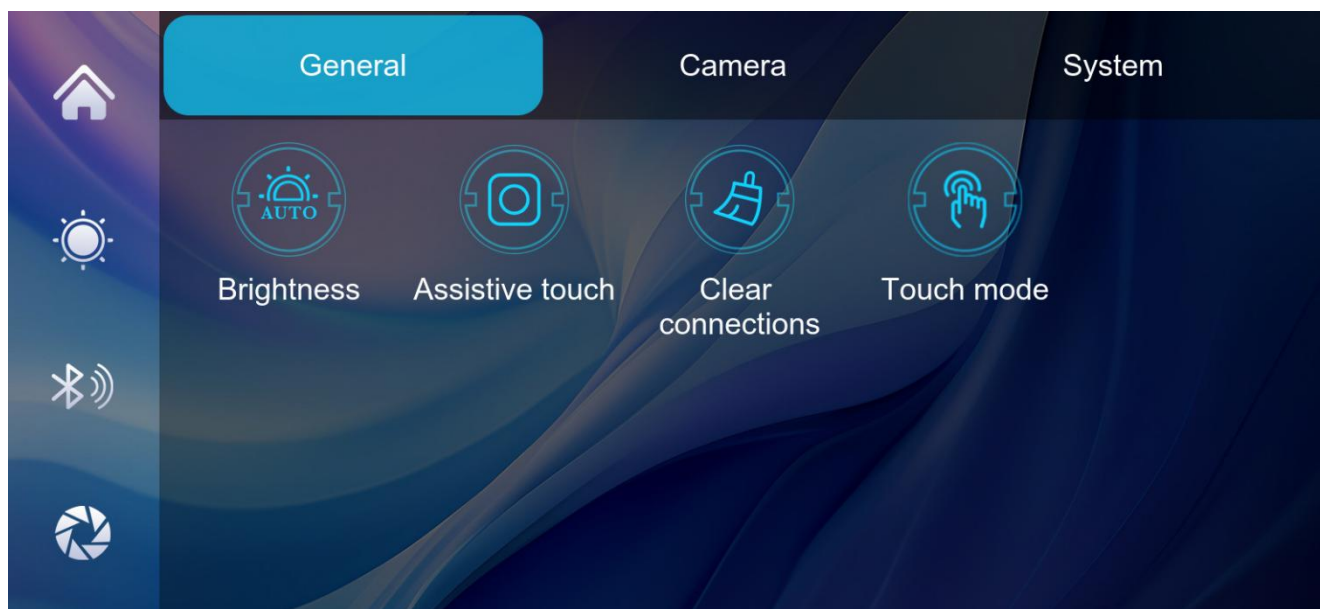

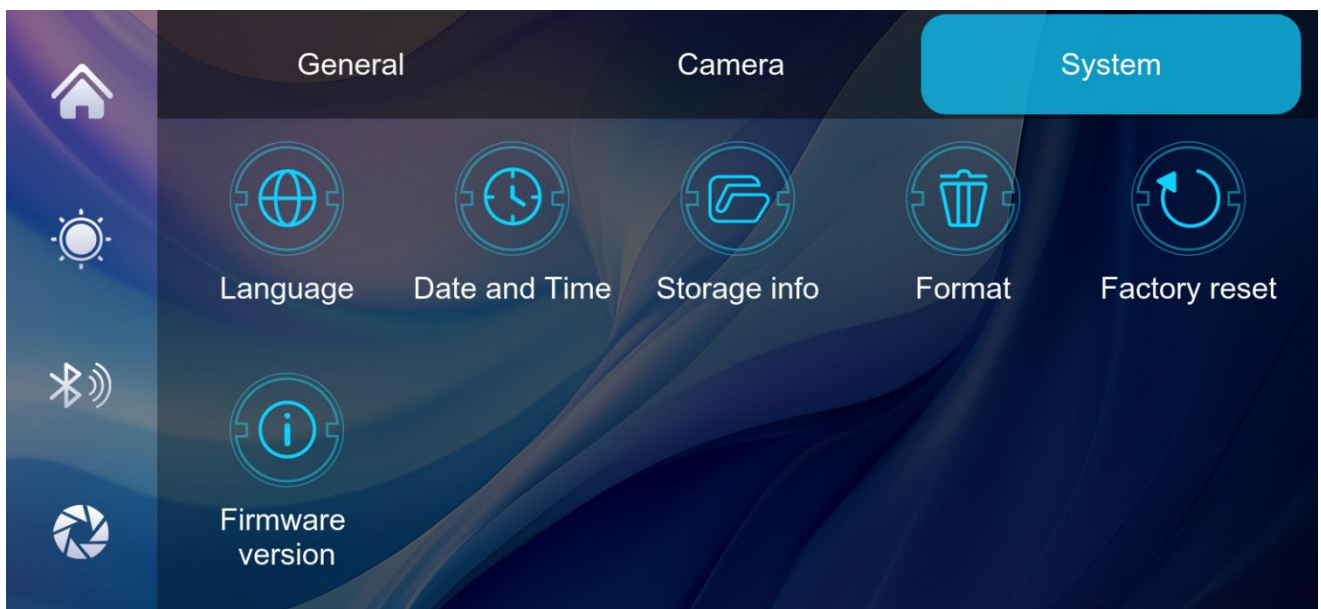



Camera: Camera format, Record resolution, Split time, Microphone, Rear mirror image

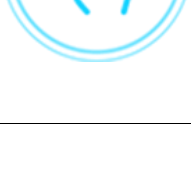



System: Language, Date and Time, Storage info, Format, Factory reset, Firmware version





	[Brightness] See below for details.
	[Assistive touch] It's a hover window button in your phone's screen casting mode, you can choose to turn it off or on.
	If the customer has changed mobile phones, click to clear the connection records of all previous mobile phones.
	[Touch mode] You can select [Normal mode] or [Rainwater mode]. Only when Rainwater mode is selected, the touch disable function can be enabled by long pressing the square control button. In Normal mode, long pressing the square control button is not effective.
	Click on [Camera Format] to input settings: 720P/720N/1080P/1080N Note: Selecting an unrelated camera system will result in abnormal display and video images. If the camera display screen or color is abnormal, please check if the corresponding camera system has been selected.

	<p>Click to enter the [Record resolution] settings: 720P / 1080P (different models, options will be somewhat different, subject to the actual object)</p>
	<p>Click on [Split time] to enter the video segmentation time setting: Video segmentation time can be selected: 1 minute / 3 minutes / 5 minutes. The system defaults to 3 minutes. The recorded video is also a default of 3 minutes per segment.</p>
	<p>Click [Microphone] to enter the settings: You can choose to turn it off or on, and the recorded video will not have any sound after turning it off.</p>
	<p>Click on [Rear mirror image] to enter the settings: you can choose to turn it off or on. After opening, the rear camera screen will mirror and display. This option makes it easier for customers to flexibly install cameras.</p>
	<p>Click on [Language] to enter settings: Language can be set: Simplified Chinese / Traditional Chinese / English / Russian / Spanish / French / German / Japanese / Korean / Italian / Portuguese</p>
	<p>Click on [Date and Time] to enter settings: separate settings: Year / month / day / hour / minute / second / time format</p>

	<p>Click [Storage Info] to enter the menu: You can view the information of the SD card. The former item indicates the remaining available capacity, and the former item indicates the total capacity.</p>
	<p>Click [Format] button will delete all data information from the SD memory card.</p> <p>It is recommended to manually format the SD card when inserting it for the first time to ensure sufficient card capacity.</p> <p>Note: It is recommended that users manually format the SD card regularly.</p>
	<p>Click [Factory reset] to enter the settings:</p> <p>Restore factory settings, the system will restore all settings to their original state</p>
	<p>Click on [Firmware version] to enter the menu:</p> <p>This option allows you to see the current software version number</p>

Brightness :

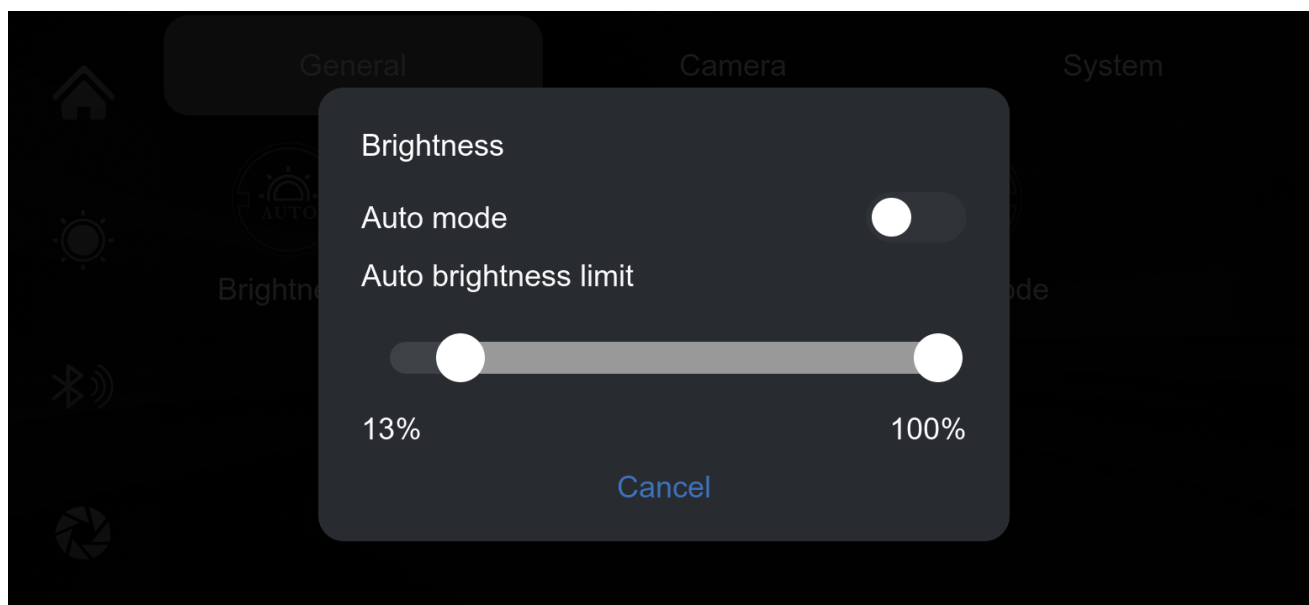

You can set the auto-brightness on or off, and you can also set the auto-brightness minimum and maximum brightness values.



When Auto Brightness mode is turned on, you cannot adjust the volume manually. Drag the left white dot button to set the minimum brightness value, and drag the right white dot button to set the maximum brightness value. The setting will be saved automatically when it is completed, and you can exit the setting by clicking the [Cancel] button.

Common problems

Number	Problem	Solution
1	Unable to start	<p>1. Check whether the power cord is damaged or aged</p> <p>2. Check whether the fuse of the power cord is disconnected or burnt out</p>
2	No touch phenomenon	<p>1. Touch is invalid during power-on, wait for normal power-on before operation.</p> <p>2. Check whether the touch is damaged, do not touch the screen with sharp objects, it is easy to scratch and damage.</p> <p>3. The machine has turned on rain mode and disabled touch function. You can press and hold the third button for 5 seconds to unlock touch.</p>

3	No image from camera	<p>1. Use only after using the manufacturer's matching camera.</p> <p>2 The camera connector is not loose.</p>
4	High temperature lag phenomenon of the mach	<p>1. The normal operating temperature of the MT02 is -4 to 149 F. If the temperature exceeds the limit, disconnect the power supply and the temperature of the MT02 will be lower than 149 F before switching on the power.</p>
5	Carplay cannot connect	<p>1. The first connection takes a little longer.</p> <p>2. Only iPhone supports Carplay.</p> <p>3. Check that the WiFi and Bluetooth functions of the mobile phone are normal.</p> <p>4. Enter Settings - General -Carplay vehicle, delete all records and reconnect.</p> <p>5. Restart the iPhone and reconnect it.</p> <p>6. Turn on the Siri function on your phone.</p>

6	Auto cannot connect	<ol style="list-style-type: none"> 1. Only Android phones are supported. 2. Update Auto and related applications on mobile phones to the latest version. 3. Do not enable VPN on the mobile phone. 4. Check that the WiFi and Bluetooth functions of the mobile phone are normal. 5. Restart the Android phone and connect it again.
7	WiFi Video cannot connect	<ol style="list-style-type: none"> 1. Try to upgrade the version of the application. 2. Check if the SD card of the machine exists. 3. Check if the machine's mode has been switched to WiFi video mode.

Product specifications

Model	MT02
Master control	High performance SOC
Wireless function	CarPlay / Auto / WiFi Video
Screen	6.25 inch high-definition IPS screen, 1560 * 720
Storage	32G ≤ SD ≤ 256G (Class10)
Wireless module	WiFi / Bluetooth / Audio
Camera	Recording from both front and rear cameras
Audio output	BT Audio
Video	TS streaming
Working voltage	5V-30V
Power	Less than 10W
Size	160*85*30mm
Weight	About 130g
Material quality	ABS/PC



www.hyperdash.online